

Step-by-step guide

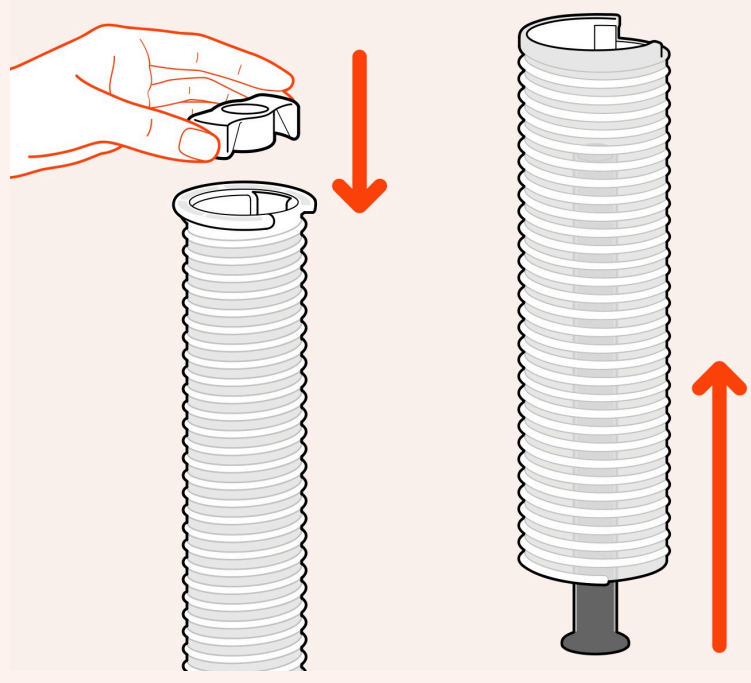

Put the reel together as shown so it's easier to load the film in the dark later.

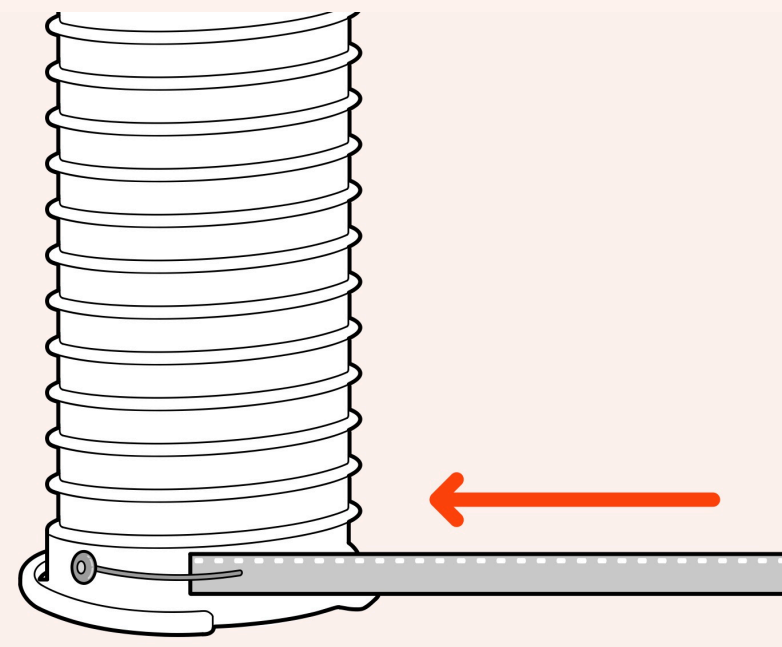

Secure the end of the film onto the reel while you're still out of the changing bag.

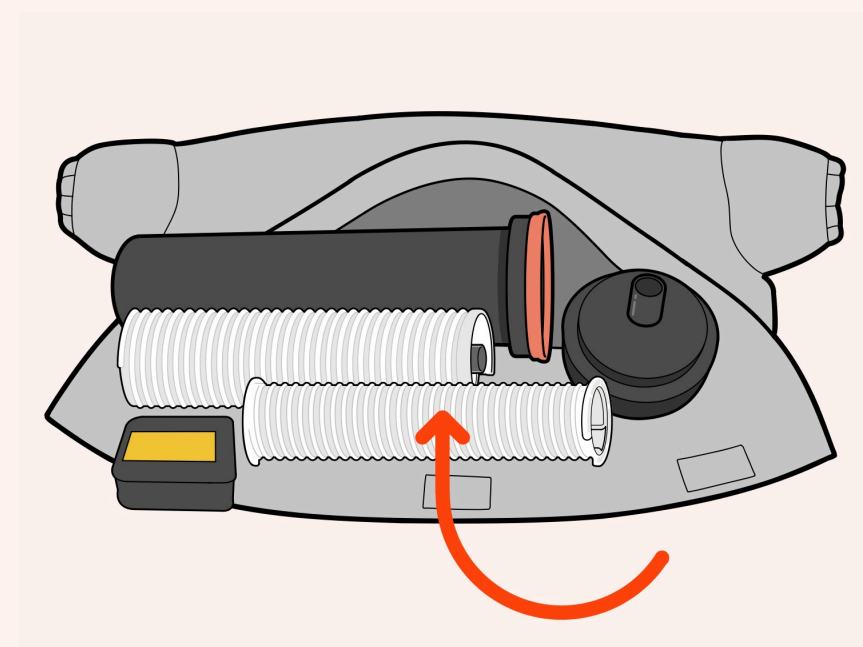

Take reel, film, tank, funnel, roller base and rubber band into the changing bag in preparation for loading film in the dark.

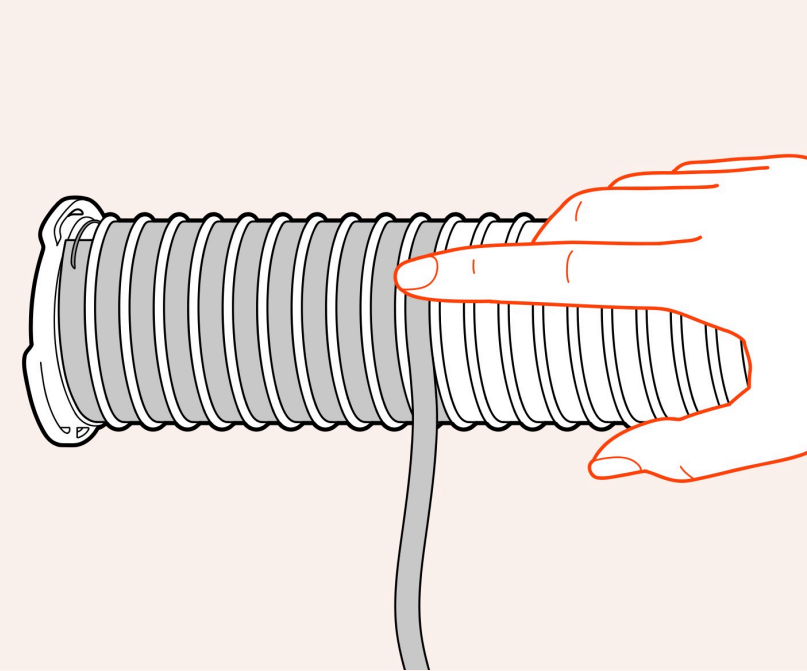

Load the film onto the inner reel, use your finger to guide it into the correct groove.

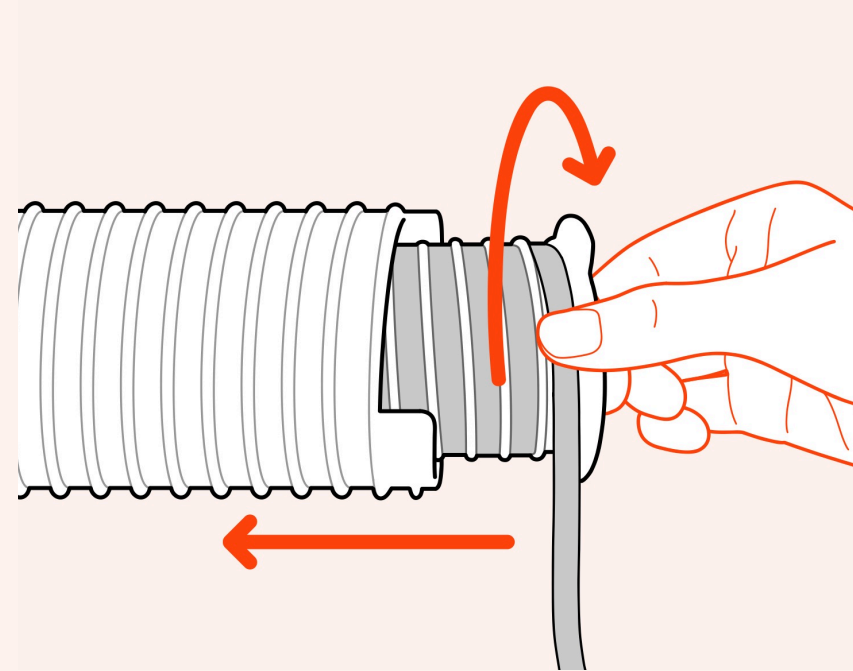

Insert the inner reel into the outer reel and lock them together by twisting inner reel clockwise. The same time hold film in place with your thumb.

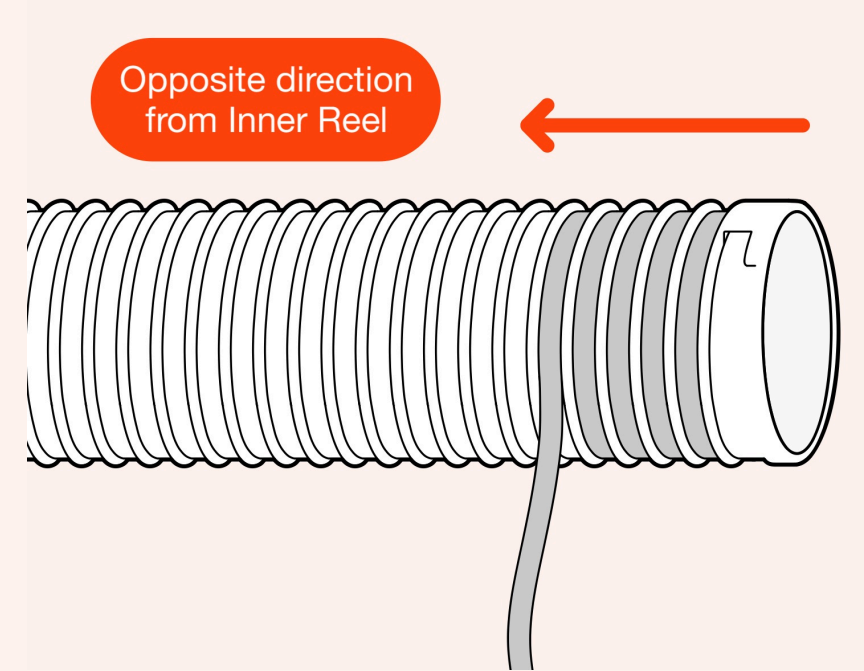

Load the film onto the outer reel in the opposite direction.

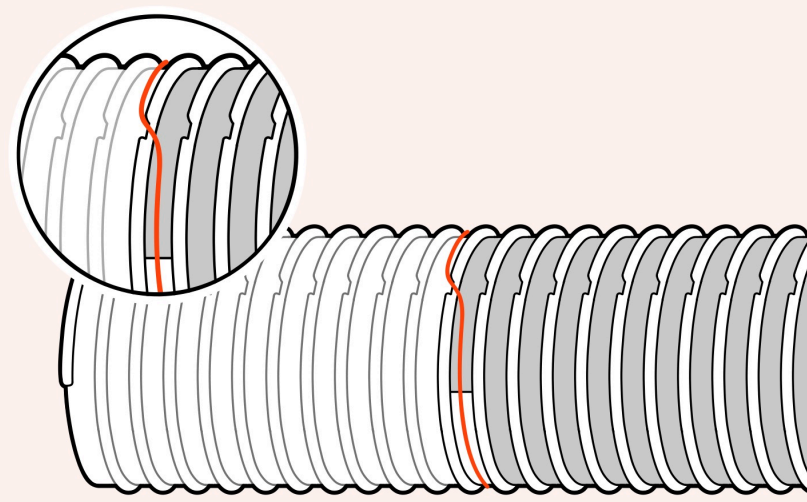

Secure the end of the film with a rubber band. Ensure that the rubber band goes through the slot on the reel to prevent it from rubbing against the tank wall during processing.

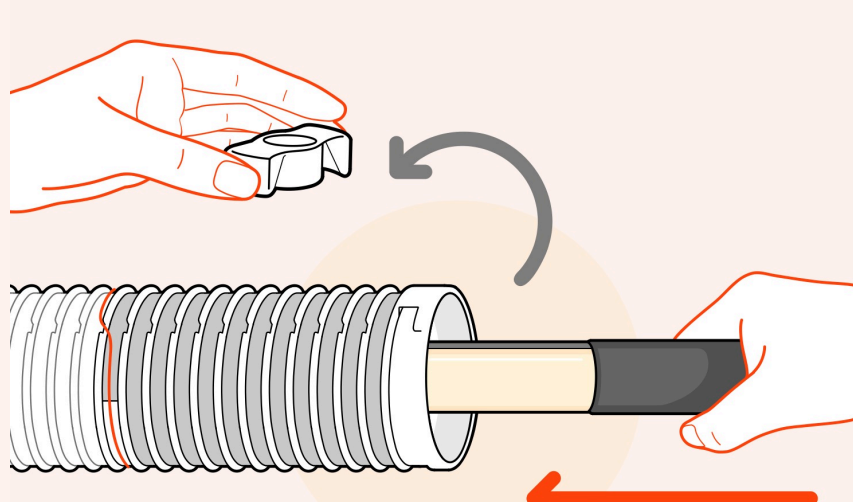

If second exposure is needed, remove the small inner clip to allow the light bar to fit inside the reel to expose the inner reel. Outer reel you can expose from outside.

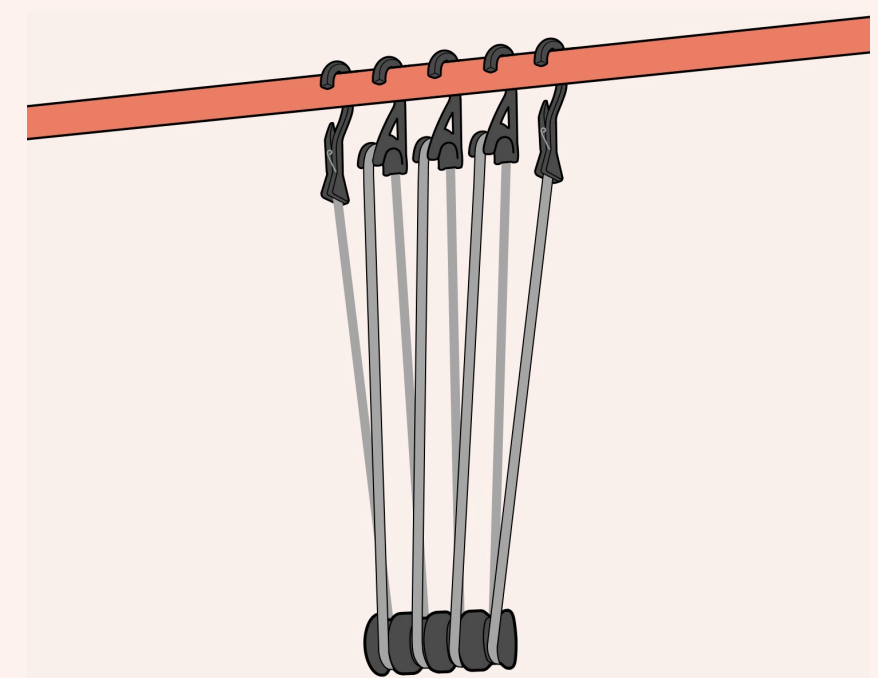

After developing the film, use hooks to hang it for drying.